

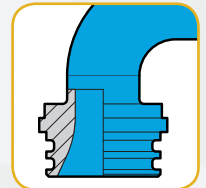

Introduction to BMRS Custom Parts

A significant and expanding part of the fitting range offered is Custom Parts. Whilst originally these designs may have been introduced to resolve a single customer's need, many of them have wider application.

The following pages show a small selection of these Custom Parts. Please contact us for further details of these fittings or to discuss your specific fitting needs.

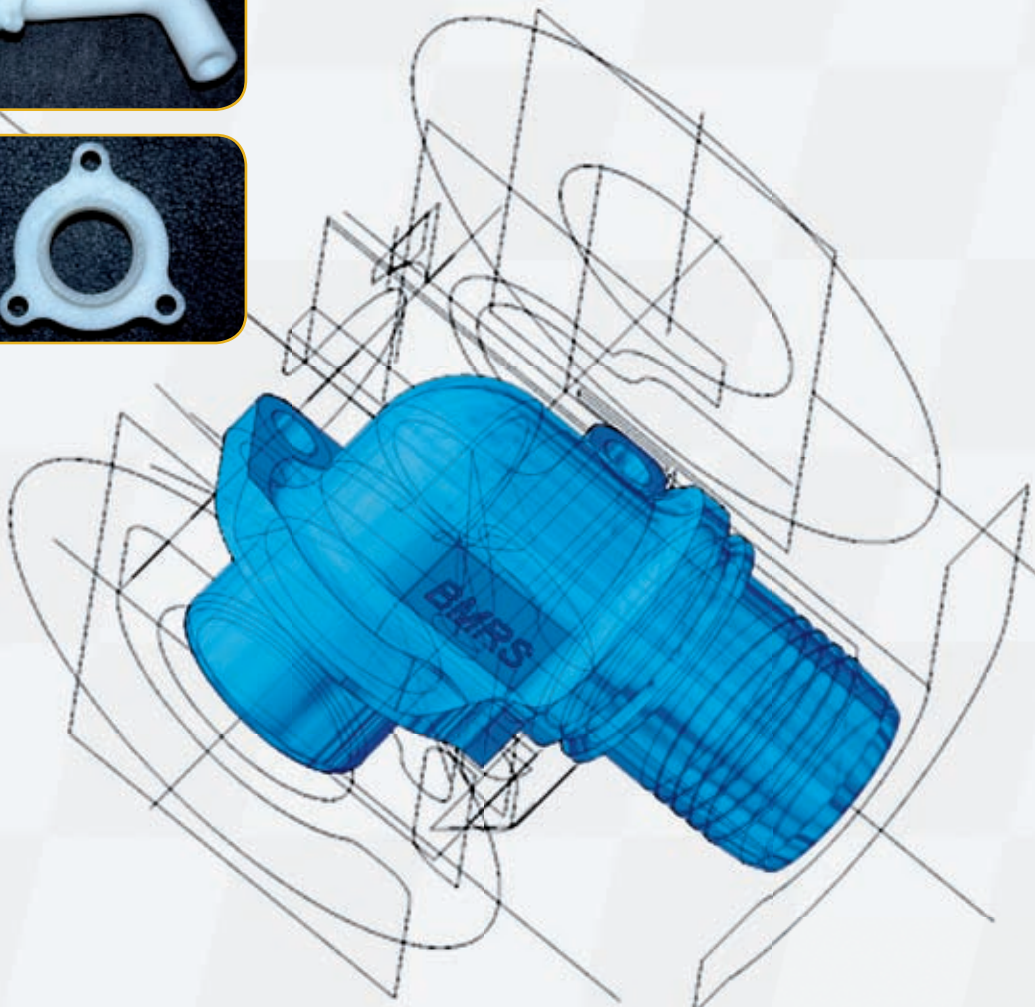



'O' Ring Head

Port details available upon request

Straight

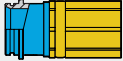

Fitting part no.	Hose
AC-16-0041-00	-16

45° Elbow

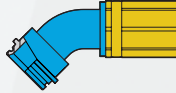

Fitting part no.	Hose
AC-16-0041-45	-16

90° Elbow

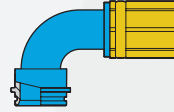

Fitting part no.	Hose
AC-16-0041-90	-16

Keep Plate for AC-16-0041

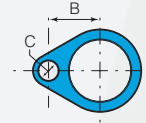

Supplied with the fitting

'B' ins	'B' mm	'C' ins	'C' mm
1.07	27.3	13/32	10.31

Straight

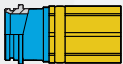

Fitting part no.	Hose
AC-20-0003-00	-20

45° Elbow

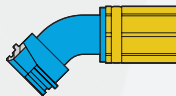

Fitting part no.	Hose
AC-20-0003-45	-20

Keep Plate or AC-20-0003

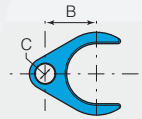

Supplied with the fitting

'B' ins	'B' mm	'C' ins	'C' mm
1.07	27.3	13/32	10.31

Double 'O' Ring Head

Port details available upon request

30° Elbow

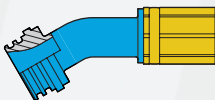

Fitting part no.	Hose
AC-12-0042-30	-12

45° Elbow

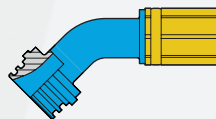

Fitting part no.	Hose
AC-12-0042-45	-12
AC-16-0040-45	-16

60° Elbow

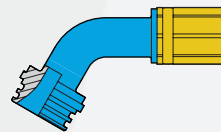

Fitting part no.	Hose
AC-12-0042-60	-12

70° Elbow

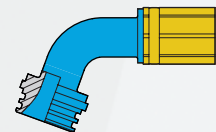

Fitting part no.	Hose
AC-10-0022-70	-10

80° Elbow

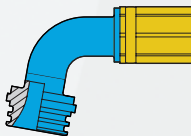

Fitting part no.	Hose
AC-10-0022-80	-10

90° Elbow

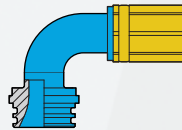

Fitting part no.	Hose
AC-10-0022-90	-10
AC-12-0042-90	-12

90° Elbow with Integral Filter Screen

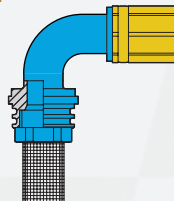

Fitting part no.	Hose
AC-10-0022-90F	-10
AC-12-0042-90F	-12

Keep Plate for AC-12-0042

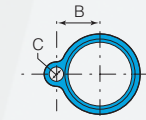

Supplied with the fitting

'B' ins	'B' mm	'C' ins	'C' mm
0.656	16.66	0.203	5.16

Filter Screen supplied separately.



Flange 'O' Ring Head

Port details available upon request

Straight

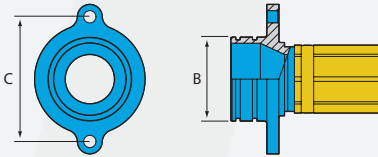

Fitting part no.	Hose size	B ins	mm	C ins	mm
AC-20-0004	-20	1.75	44.4	2.60	66.0
AC-24-0004	-24				

Straight Swivel Flange

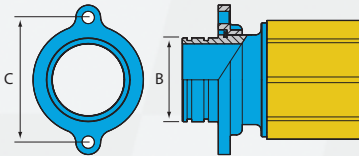

Fitting part no.	Hose size	B ins	mm	C ins	mm
AC-32-0006	-32	1.75	44.4	2.60	66.0

Elbow 12.75° Swivel Flange

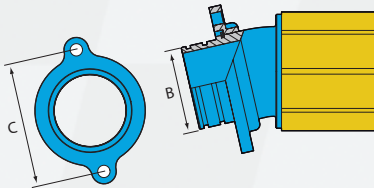

Fitting part no.	Hose size	B ins	mm	C ins	mm
AC-32-0004	-32	1.75	44.4	2.60	66.0



USA: (704) 793 4319 UK: 01753 545554 WEB: www.bmrs.net

Custom Parts

Inline Joiner Swivel 1/8" NPT Port

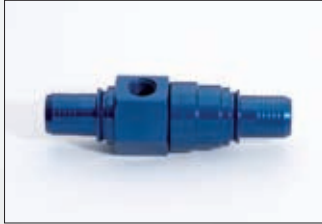

Fitting part no.	Hose
AC-10-0025	-10

Inline Joiner Fixed Two 1/8" NPT Ports



Fitting part no.	Hose
AC-12-0026	-12

Inline Joiner Fixed 1/8" NPT Port



Fitting part no.	Hose
AC-12-0054	-12

JIC Bulkhead Extra Long



Fitting part no.	Hose
AC-16-0030	-16

Male Swivel 1 1/16 x 12 Big Thru Bore



Fitting part no.	Hose
AC-16-0039-45	-16

'O' Ring Fitting TRD



Fitting part no.	Hose
AC-12-0023	-12

Double 'O' Ring Fitting Ford FR9



Fitting part no.	Hose
AC-12-0055	-12

'O' Ring + Filter Housing



Fitting part no.	Hose
AC-12-0051	-12

'O' Ring + Filter Housing 90° Swivel



Fitting part no.	Hose
AC-12-0052	-12

Flanged Fitting Straight



Fitting part no.	Hose
AC-16-0021	-16

Flanged Elbow 30°



Fitting part no.	Hose
AC-16-0011-30	-16

Flanged Elbow 45°



Fitting part no.	Hose
AC-16-0011-45	-16

3 Bolt Flange 90°



Fitting part no.	Hose
AC-12-0020	-12

3 Bolt Flange 80°



Fitting part no.	Hose
AC-16-0009	-16

3 Bolt Flange 90°



Fitting part no.	Hose
AC-16-0024	-16



Custom Parts

**4 Bolt Flange 90°
Auto Verdi Pump**



Fitting part no.	Hose
AC-16-0012	-16

**4 Bolt Flange 90° with Flange
Offset 7° - Auto Verdi Pump**



Fitting part no.	Hose
AC-16-0037	-16

**4 Bolt Flange 90°
Auto Verdi Pump**



Fitting part no.	Hose
AC-12-0022	-12

**4 Bolt Flange 90°
Barnes Pump**



Fitting part no.	Hose
AC-16-0028	-16

**4 Bolt Flange 90° with Flange
Offset 25° - Barnes Pump**



Fitting part no.	Hose
AC-16-0033	-16

**90° Elbow -16 Wiggins Male
4 Bolt Flange Barnes Pump**



Fitting part no.	Hose
18-0069-16-3	-16

**90° Elbow -16 Wiggins Male
4 Bolt Flange Dailey Pump**



Fitting part no.	Hose
18-0172-16-3	-16

**4 Bolt Flange 70° with Flange
Offset 5° - Auto Verdi Pump**



Fitting part no.	Hose
AC-16-0032	-16

**4 Bolt Flange 65°
Auto Verdi Pump**



Fitting part no.	Hose
AC-16-0017	-16

**4 Bolt Flange 45°
Auto Verdi Pump**



Fitting part no.	Hose
AC-16-0013	-16

**4 Bolt Flange 45° with Flange
Offset 15° - Auto Verdi Pump**



Fitting part no.	Hose
AC-16-0038	-16

**4 Bolt Flange 90°
Auto Verdi Pump**



Fitting part no.	Hose
AC-16-0016	-16

**4 Bolt Flange 90° with Flange
Offset 25° - Auto Verdi Pump**



Fitting part no.	Hose
AC-16-0025	-16

**4 Bolt Flange Straight
- Auto Verdi Pump**



Fitting part no.	Hose
AC-16-0034	-16

'O' Ring Head 90° Elbow



Fitting part no.	Hose
AC-06-0020-90	-06



Custom Parts

Dailey Pump Outlet to -16 Straight



Fitting part no.	
AC-16-0049-00	-16

Dailey Pump Outlet to -16 45° Elbow



Fitting part no.	
AC-16-0049-45	-16

Dailey Pump Outlet to -16 90° Elbow



Fitting part no.	
AC-16-0049-90	-16

OEM Style Fuel Line Connection



Fitting part no.	Hose
AC-06-0018-90	-06

OEM Style Fuel Line Connection



Fitting part no.	Hose
AC-06-0018-120	-06

OEM Style Fuel Line Connection



Fitting part no.	Hose
AC-06-0019-90	-06

OEM Style Fuel Line Connection



Fitting part no.	Hose
AC-06-0019-120	-06

Fuel Line Connector OEM SAE2044 5/16" (8mm) Straight



Fitting part no.	Hose
AC-06-0032-00	-06

Fuel Line Connector OEM SAE2044 5/16" (8mm) 90° Elbow



Fitting part no.	Hose
AC-06-0032-90	-06